

www.hazalguvenlik.net



Hydraulic Tyre Killer

Data Sheet

www.hazalguvenlik.net

Hydraulic Tyre Killer

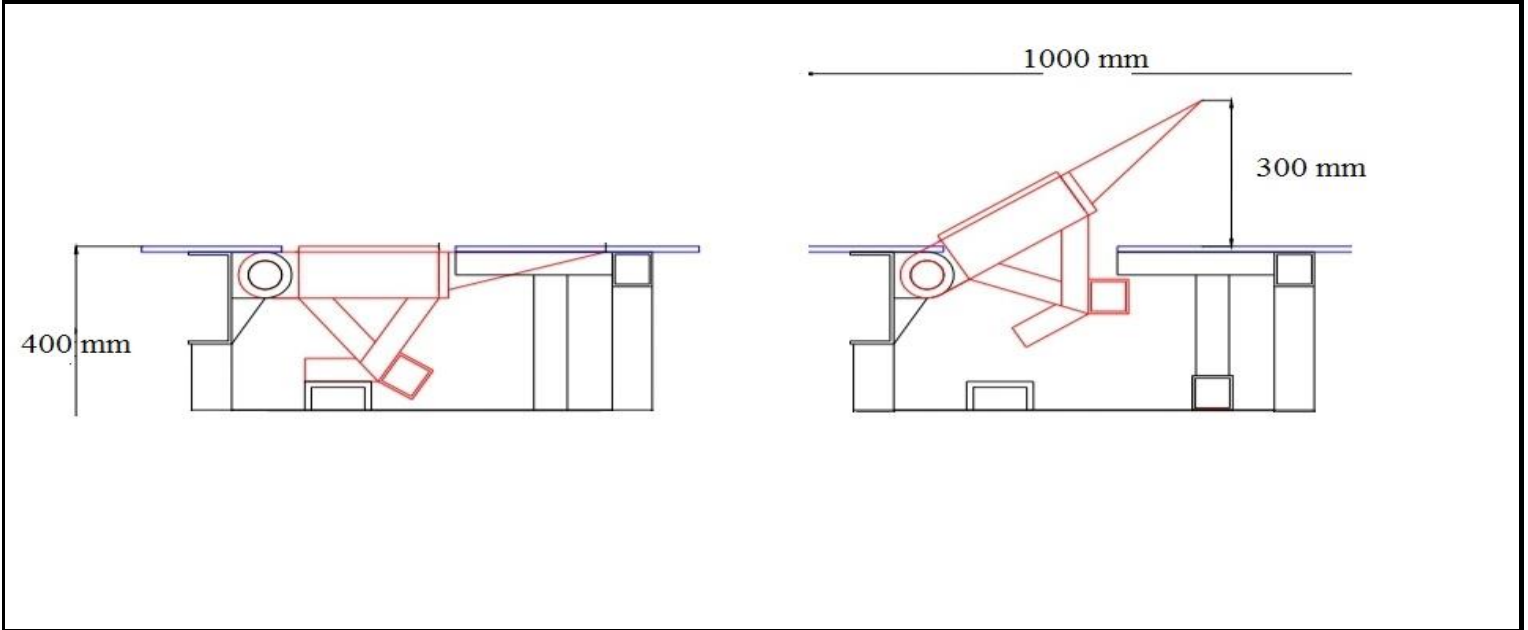

Height when raised	300 mm
Weight (approximately)	900 kg
Axle load	22 tons
Top plate	hardened teeth rise , painted to yellow with black stripes
Type of steel	S235/RAEX250-Quality 37 minimum
Red/green LED traffic light	Available, 100mm diameter, steel post 2 mt height
Hinges	reinforced steel
Power	380 V, 3 Phase, 50-60 Hz
Power failure	Manual hand pump
Raise lower time	3-5 seconds - in emergency 1.5 seconds (optional)
Desktop keyboard	Raise, lower, emergency stop, key operated, 'keyboard in use' light indicator
Controller Type	PLC Electronic Control Unit
Loop detector	This detector is used for safety
Power Back-up system (options)	Hydraulic accumulator, DC motor and batteries, UPS
Cabinet	IP 65 with continuous ventilation
Motor Power	Min 3 KW, 1500 rpm
Environmental conditions	-20 °C and +75 °C



Doğuş Mah Ballıbaa Sok No : 67/3 K.Esat / Çankaya / ANKARA

Tif : + 90 312 478 2028 – + 90 312 482 0484

www.hazalguvenlik.net - info@hazalguvenlik.net